



Von Kopenhagen nach Bern

Sicher dank Best Practice
Veloinfrastruktur

Postkartenidylle



Bern

Höhenunterschied:
ca. 4`000m

Bausubstanz

1191

UNESCO-Welterbe

Strassen

Pferd-Pferd
gepflästert









An aerial photograph of a city, likely Bern, Switzerland, taken from an elevated position. The city is built on a hillside, with a dense cluster of buildings featuring red-tiled roofs. A prominent, tall, dark Gothic church spire stands out in the center. To the right, a river flows through the city, bordered by lush green trees. The foreground is dominated by large, leafy trees with vibrant green and yellow foliage, suggesting an autumn setting. The sky is a pale, hazy yellow, indicating a soft light source like the sun. Overlaid in the center of the image is the text "5%" in a large, white, sans-serif font.

5%

An aerial photograph of a city, likely in a valley, showing a dense urban area with a river winding through it. The surrounding landscape is a mix of green fields and brown patches, possibly indicating agricultural land or forest. The text '100%' is overlaid in the center of the image in a large, white, sans-serif font.

100%







Eng und hügelig?



**Welche Brücke ist
breiter?**

Welche Geschichten erzählen wir?

BERN







Masterplan Veloinfrastruktur



Neu

Standard

Ausnahme

Transfer 1:

2.50m

Standards



Nebeneinander/Überholen

2.50 m

-> stets anzustreben



Veloanhänger

1.80 m

-> Minimum für Haupttrouten



Stadtvelo

1.50 m

-> Minimum











Transfer 2:

Baulich abgetrennte Radwege

Für Verkehrsplaner/innen:

„Strassenbegleitender

Einrichtungsrادweg nach Kopenhagener

oder niederländischer Art“



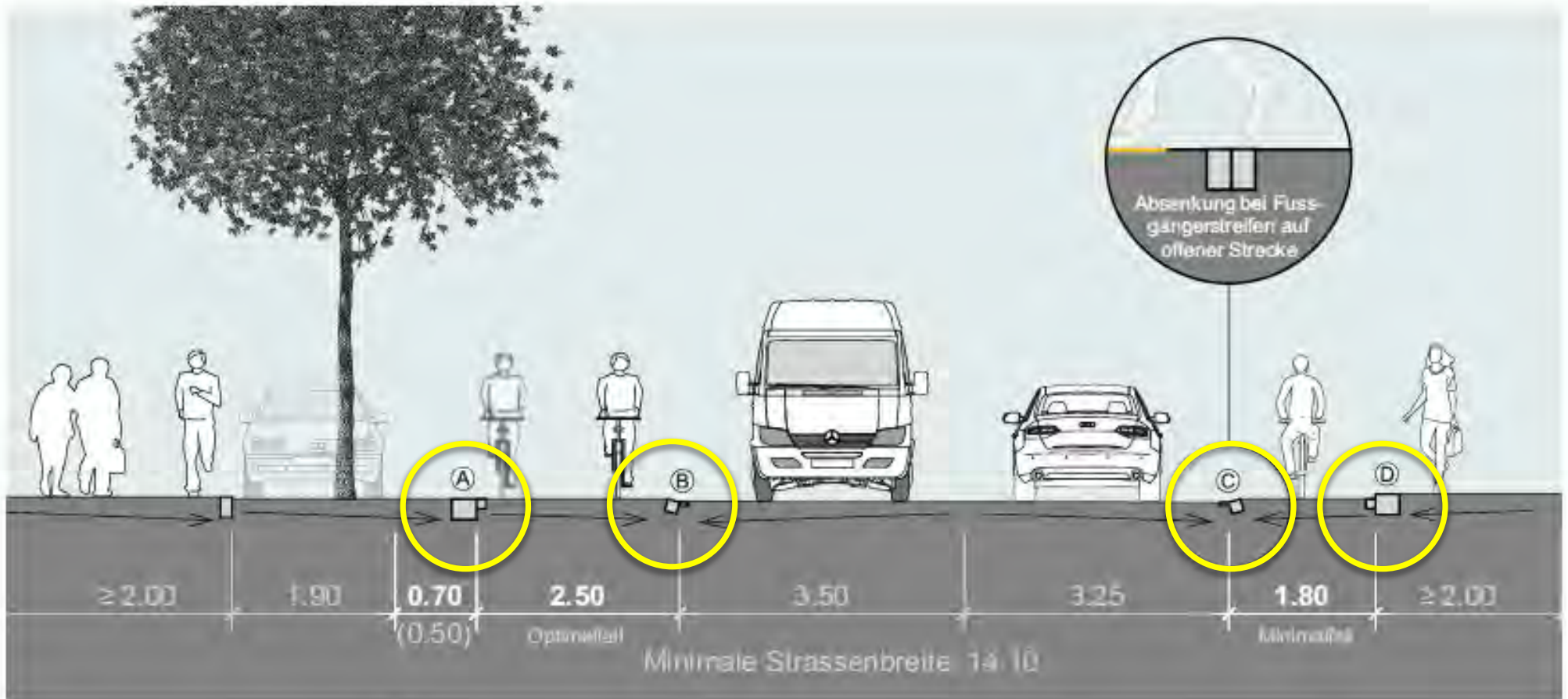









Transfer 3:

Knoten à la NL & DK



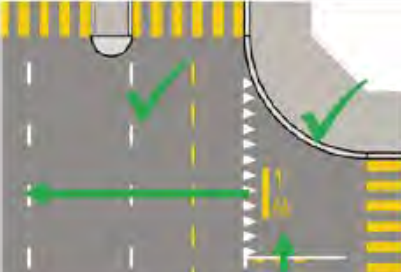

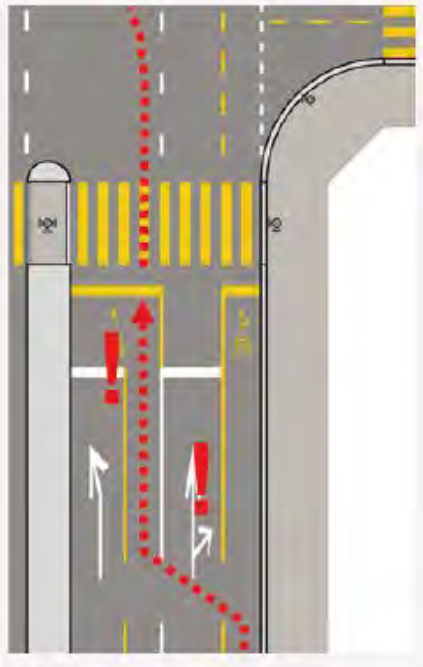
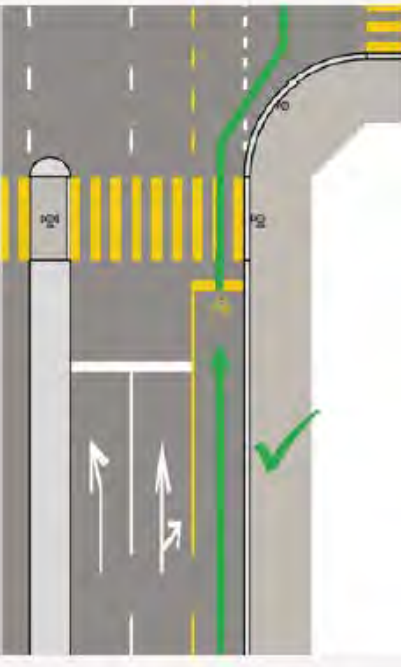
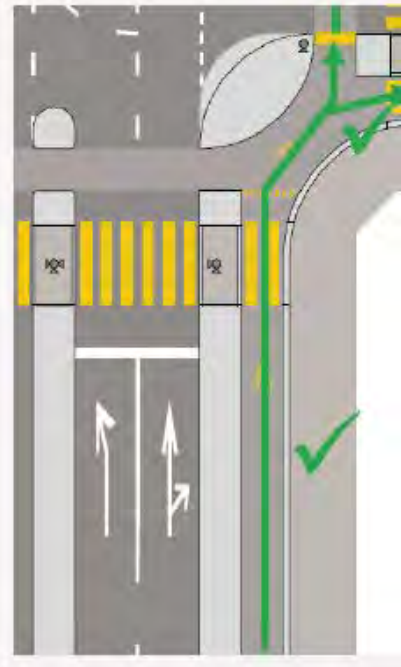
"Schweizer Lösung"	"Kopenhagener Lösung"	"Niederländische Lösung"
		
		
<p>Alle Radstreifen sind schmal</p>	<p>Ein Radstreifen ist breit</p>	<p>Ein Radweg ist breit</p>
<p>Angebot Velo: 1.80 m + 1.50 m</p>	<p>Angebot Velo: 2.50 m</p>	<p>Angebot Velo: 2.00-2.50 m</p>





Neu

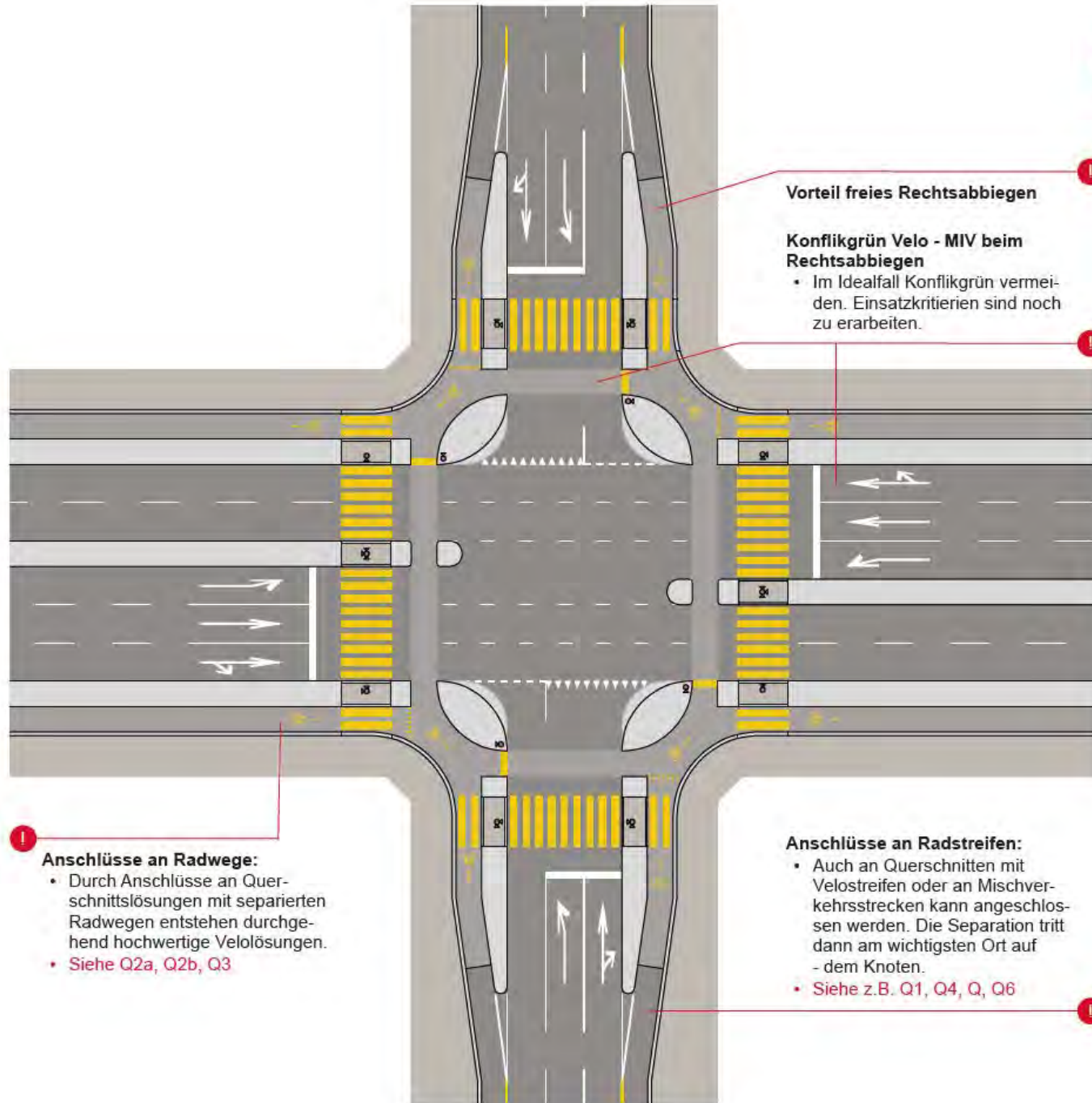

Transfer 4:

Velo und ÖV



Hotel
La Bohème

Maître d'hôtel

F

HOTEL
BOHÈME

RENTREE
DES ÉLÈVES



Transfer 5:

Safety by numbers



Safety by numbers

Killed cyclists
per 100 million km

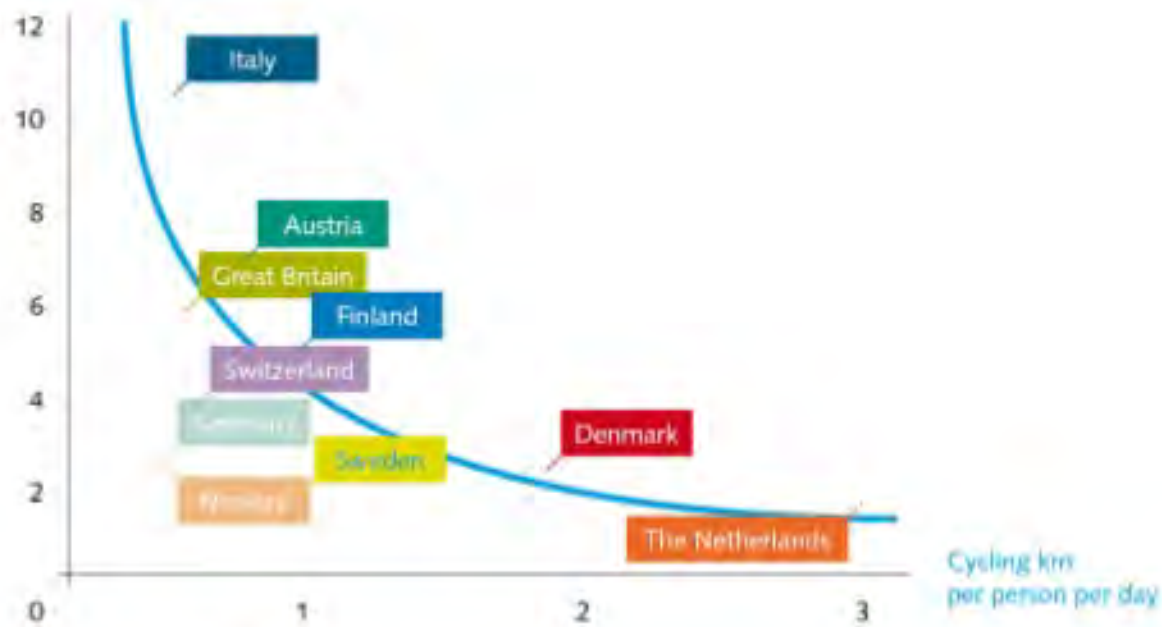

Figure 6: Relation between accidents and bicycle usage

Dutch Cycling Embassy



**Sicher sein
*und sicher fühlen***

Best Practice Infrastruktur



Mehr Velos



Bessere Wahrnehmung



Höhere Sicherheit



Transfer 6:

Die lange Frist im Auge behalten







fietsstraat
auto te gast

30

🚲
🚲🚗

ESCORT
NL-HG-73 NL



Einladung SVI-Fachtagung

**Neue Verkehrskultur in Ortszentren
- Erfahrungen mit „Shared Space“**

Dienstag, 27. Mai 2008

9.20 - 16.00 Uhr, Aula Oberstufenzentrum Köniz



www.visitcopenhagen.com

velo HAUPT
STADT





Happy Cycling!

2014-2017

